



# 1395 Candelero Drive

Walnut Creek, CA 94598

**Estimated Total Finished  
Square Footage: 1,520 sqft**

Main Level: 1,108 sqft

Upper Level: 412 sqft

**Estimated Total Unfinished  
Square Footage: 548 sqft**

Garage: 438 sqft

Upper Storage: 110 sqft

Interior room dimensions are shown, but  
all square footage is calculated from the  
outside perimeter of exterior walls.

Balconies, porches, and patios are not  
included in calculations.

Measured on July 25th, 2024

**Upper Level**  
approx. 412 sqft  
(+110 sqft Storage)

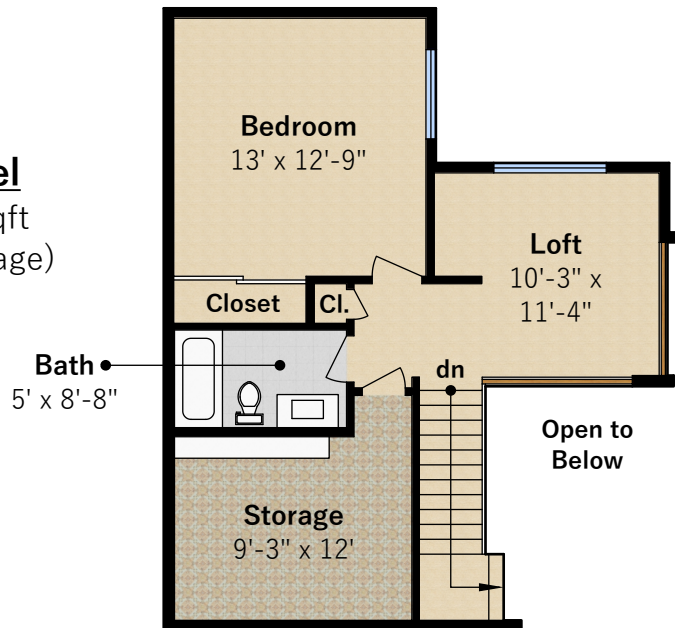

**Main Level**  
approx. 1,108 sqft  
(+438 sqft Garage)

Any and all information on this drawing is  
for illustrative purposes only and is deemed  
reliable, but not guaranteed. All information  
requires independent verification.

**Listed By: Ken Jacobs**

Clocktower Realty | [www.clocktowerrealty.com](http://www.clocktowerrealty.com)

